

# Shepaug Crossing Preserve

## Trail Map

This preserve, granted to the Litchfield Land Trust by C.A. Litchfield LLC in 2011, is located on the western edge of Litchfield. Encompassing 80 heavily-wooded acres, it extends nearly a mile in length along the eastern slope of the Shepaug River valley and includes 3400 feet of pristine river frontage. Lying downstream of the Lower Shepaug Reservoir owned by the City of Waterbury and upstream of the extensive river corridor protected by the Steep Rock Association, it is a key link in the river's protection. The preserve includes remains of the Shepaug Turnpike and the Hitchcock-Pratt-Peters iron works constructed in the late 18<sup>th</sup> century.

### Litchfield Land Trust



P.O. Box 712, Litchfield, CT 06759

[www.litchfieldlandtrust.org](http://www.litchfieldlandtrust.org)

Founded 1968

*Funding for this map generously provided by The Community Foundation of Northwest Connecticut*



The trail, indicated by blue blazes, consists of a main stem and a loop, totaling about 3 miles. The route mostly traverses moderate slopes, but includes a relatively short steep portion and occasional rocky and wet areas. The trail begins 3.2 miles west of the village of Bantam, on the north side of Route 202, approximately 300 feet west of the entrance of Garland Road and an equal distance east of the Shepaug River bridge.

The stem trail proceeds alternately upslope and cross-slope through oak-birch-hemlock forest, occasionally crossing small seasonal streams and boulder-strewn areas. It then turns downhill through one switchback and crosses another small stream. Shortly thereafter, a spur trail to the right leads to Little Knoll, which provides some views when the leaves are down. The stem trail continues descending and passes between ancient 'borrow pits' where stone was extracted, and finally meets the laneway of the old turnpike and bears right. The loop portion of the trail begins about 50 feet further along where one leg continues up the old road and the other turns left towards the river. Taking the latter option, one shortly reaches the river's edge. The trail bears to the right and heads upstream, occasionally passing old stone walls, proceeding nearer to or farther from the river, sometimes on level floodplain and sometimes along rocky riverbank. Along the way there are places to rest on a rock at water's edge. Ahead, lay the ruins of a large dam, and directly across the river the ruins of stone foundations and spillways. This is the site of the dam and the water impoundment that powered the Hitchcock-Pratt iron forge (west side, 1782) and the Peters Forge (east side, 1799); these forges converted pig iron into iron bars and sheets, suitable for further processing by others. The trail ascends the dam, and once atop it continues upstream and in 0.1 mi reaches Tumbledown Brook. Here the trail turns to the right and follows the brook uphill through occasionally rocky and steep terrain. At the top, just above the point where the trail turns right and away from the brook, the remains of an ancient bridge abutment can be observed. The trail is moderately level as it continues south, eventually meeting up with the old turnpike roadway at an intersection. The abandoned roadways lying ahead and to the left both lead shortly to private property. Turn right and follow the roadway downhill to complete the loop at the trail junction. From this point, return to the trailhead via the main stem trail.

### LLT Preserve Policies:

- Stay on designated trails
- No motorized vehicles
- No fires, swimming, hunting or trapping
- Wear orange during hunting season
- Help keep the preserve clean – no littering or dumping

**The Litchfield Land Trust** is a non-profit, member-supported organization whose mission is to preserve and protect the natural resources in the Litchfield, CT area, including water resources, marsh land, swamps, woodland, agricultural land and open spaces and the plant and animal life therein, and the preservation of unique, historical and scenic sites.

**If you value these goals and wish to support the LLT, please join us.**

- \$20 Sr Cit/Student    \$25 Friend    \$50 Family  
 \$100 Donor    \$250 Supporter  
 \$500 Benefactor    \$1000 Patron  
 \$5000 Grand Patron    Other \_\_\_\_\_

**Enter information as you would like it to appear in our membership records:**

Name \_\_\_\_\_

Street Address \_\_\_\_\_

Town \_\_\_\_\_

State \_\_\_\_\_ Zip \_\_\_\_\_

Email \_\_\_\_\_

Telephone \_\_\_\_\_

**SHEPAUG CROSSING  
PRESERVE  
77.2 ACRES  
CT ROUTE 202  
LITCHFIELD, CT  
LITCHFIELD LAND TRUST  
NOVEMBER 2013**

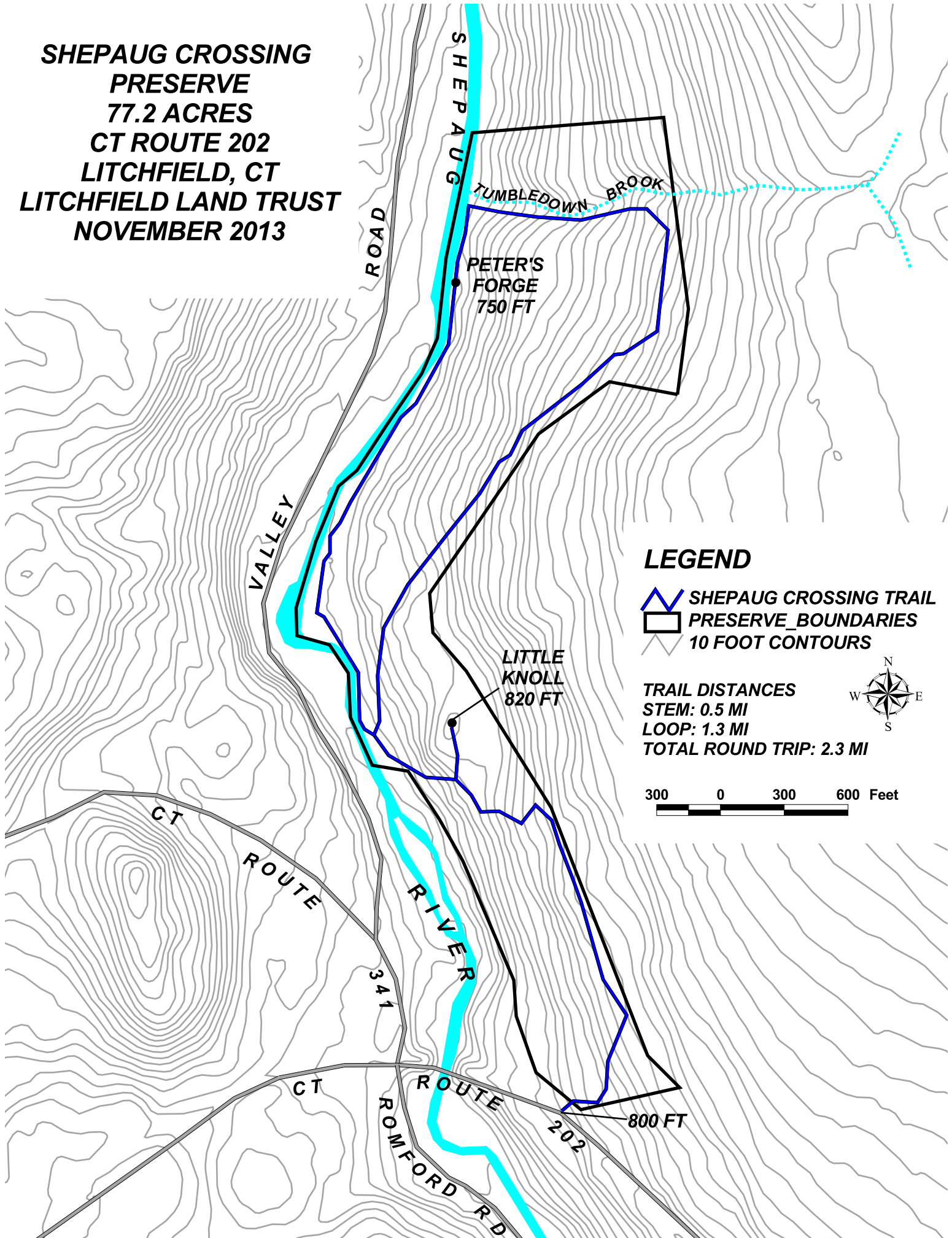

**LEGEND**

- SHEPAUG CROSSING TRAIL
- PRESERVE BOUNDARIES
- 10 FOOT CONTOURS

TRAIL DISTANCES  
STEM: 0.5 MI  
LOOP: 1.3 MI  
TOTAL ROUND TRIP: 2.3 MI

